

G631 Multi Grip PCB Rivet

Dome head · Aluminium body · Steel stem · Multi-grip
4.0 mm (5/32")

Features

- Highly effective for water-resistance and anti-vibration

Material

- Body: Aluminium alloy A5052, polished
- Stem: Carbon steel, zinc plated
- Cap: Nylon, natural

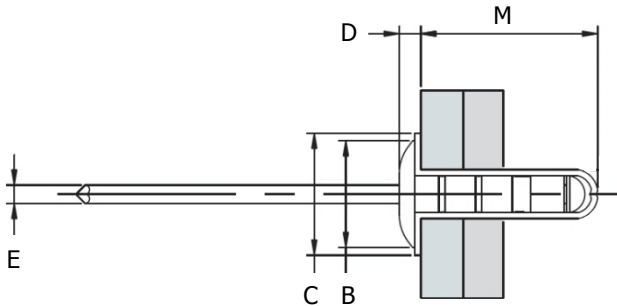

Before Placement

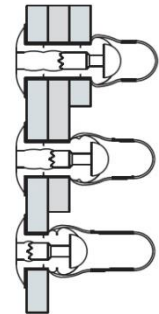

After Placement

Part No.	Size Ø	Grip Range		Hole Size		M	ØB	ØC	D	ØE	Shear (typical)	Tension (typical)
	nom.	min.	max.	min.	max.	max.	max.	max.	max.	max.	kN	kN
G631-0521	4.0 (5/32")	4.7	10.7	4.9	5.0	20.0	11.0	12.0	3.0	2.12	1.1	1.6



Can't find what you are looking for?

We can provide customized finishing and colouring.
Contact your nearest [Gripwell](#) team for assistance!